

KESTREL V2 BASIC

Programming function description

Enter Programming

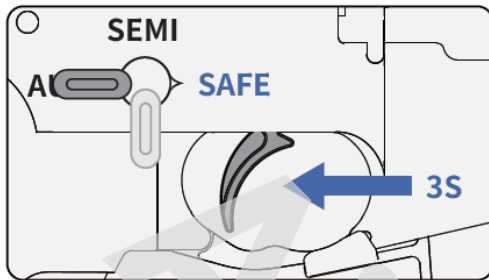

Switch the selector to the 'SAFE' and hold the trigger for 3 seconds. It will vibrate 3 times and the blue light will flash 3 times, indicating that it has entered the programming mode.

Reset

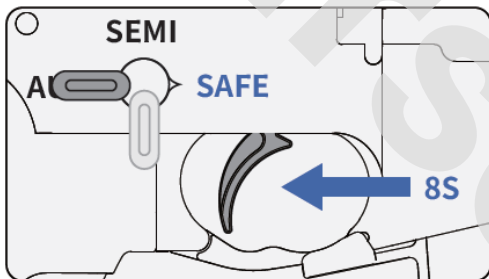

Long press 8s to reset original program (SAFE,SEMI-Single shot, AUTO-Full Auto, No pre-cocking).

Exit with Timeout

After entering programming and no operation for 8 seconds, it will automatically save and exit the programming mode.

Pre-cocking Function

After entering the pre-cocking function, you need to continuously pull the trigger to select different pre-cocking levels.

After level selecting confirm, switch the selector to „SEMI“ or „AUTO“ to determine the setting of the pre-cocking level.

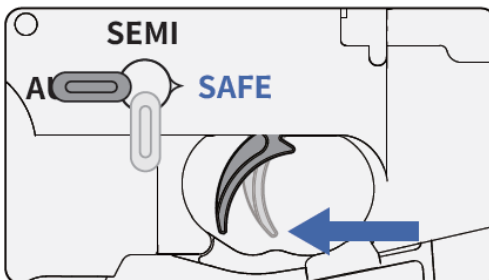

1. Pull trigger 1x : Reset pre-cocking settings
2. Pull trigger 2x : Pre-cocking level 1
3. Pull trigger 3x : Pre-cocking level 2
4. Pull trigger 4x : pre-cocking level 3
5. Pull trigger 5x : pre-cocking level 4
6. Pull trigger 6x : pre-cocking level 5

Remark

The KESTREL Basic has an original self-learning function, which can automatically determine the position of pre-cocking stop based on different speeds and loads.

After replug or unplug the battery in the pre-cocking mode, it is normal for a single shot to fire a few more rounds when the trigger is pulled for the first time.

SEMI Function

The 'SEMI' function will cycle between 'Single Shot' and 'BINARY'

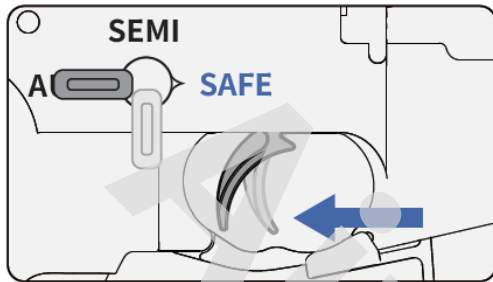

Programming switching in 'Single Shot' mode, the function will turn to 'BINARY', and next switching will be back to 'Single Shot'.

AUTO Function

After programming, trigger from AUTO to 3 Burst Shots

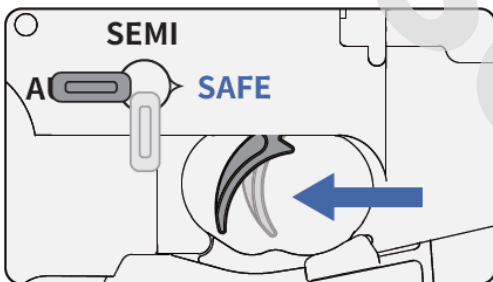

Programming switching in 'Full Auto' mode, the function will turn to '3 BURST', and next switching will be back to 'Full AUTO'.

Gel Blaster Feeding Time Setting

After entering the programming mode, pull the trigger 5 times in succession to enter this setting, pull the trigger again to select a different feed time (0.5-3 seconds):

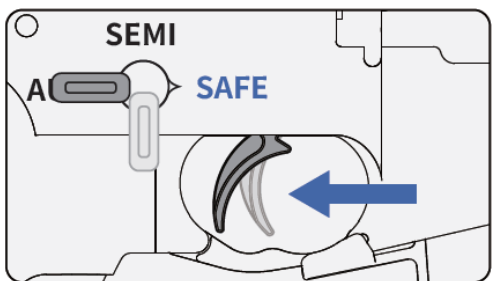

1. Pull once: Turn off the feed setting
2. Pull the trigger 2x : the feeding time is 0.5 s
3. Pull the trigger 3x : the feed time is 1.0 s
4. Pull the trigger 4x : the feeding time is 1.5 s
5. Pull the trigger 5x : the feeding time is 2.0 s
6. Pull the trigger 6x : the feeding time is 3.0 s

Vibration/Light reminder

1. Power On: Motor vibrates 1 time
2. Jammed: Motor vibrates 2 times
3. Voltage High (more than 17 V): Motor vibrates 3 times.
4. Low Battery (2s: less than 6 V, 3s: less than 8.5 V): Motor vibrates 5 times